



Installation in:

Walls

Tools you will need:

All Weather Tape
All Weather Sealant
Blu Tack
Masonry Drill
Masking Tape

Sharpened Pencil
Spirit Level
Ruler

DIY installation may involve the use of power tools or cut glass. Safety equipment (gloves, eye protection, etc.) should be used and if in doubt consult a professional to carry out the installation.

When you are making holes through the wall of your property please consult a qualified builder.

Note: When planning the installation of a SureFlap Microchip Pet Door in a wall, remember that you may need to remove the pet door if you move house or upgrade to a newer model. With this in mind, do not glue the main assembly of the unit to the wall, as removing it will be difficult and could damage the surface of your wall.

For installation of the SureFlap Microchip Pet Door in a wall, we recommend that you use Pet Door Tunnel Extenders, which can be purchased through www.sureflap.com.

Choose your mounting position on the wall ensuring that your pet will have easy access through the pet door in both directions.

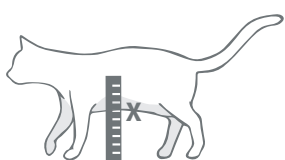

1

Measure the height of your pet's stomach from the floor when your pet is standing. This height is the level at which the bottom of the hole should be cut through the wall. Make a mark on the wall at this height. Note: If there is a large drop on the outside of the house you will need to place a step outside for your pet to access the tunnel.

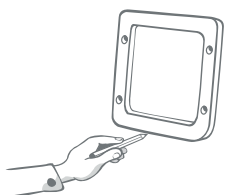

2

Take the external frame as you will need to use this as a template to mark the hole in the wall. Firstly, make a small pencil mark at the bottom of the external frame in the centre.



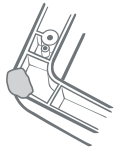

3

Put a piece of Blu Tack or similar low tack putty on the four corners of the frame.

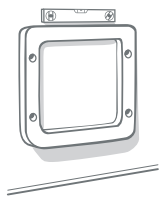

4

Stick the external frame to the wall on the inside of the house, lining up the pencil mark and bottom of the frame with the mark you have made on the wall. Use a spirit level to ensure that the frame is level.

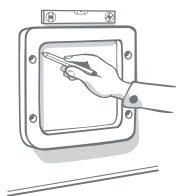

5

Using a pen or pencil draw around the inside of the frame on the wall so you have a clearly visible cutting line. You can now remove the frame from the wall.

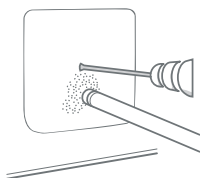

6

Before you start to cut the hole through the wall, remove the pet door from the area to minimise the amount of dust and debris the product is subjected to.

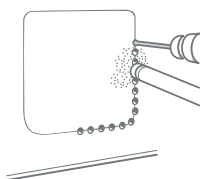

7

We do not recommend that you cut through the inside and the outside surface of the wall in one go. Cut the hole on the inside of the house first and then move outside to cut the hole there. You may want to drill one hole straight through the wall in the centre of the tunnel as a guide.

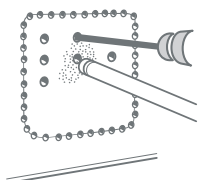

8

Whether you are cutting through brick, wood, tiles or plaster, you should drill some pilot holes first around the perimeter of the line you have drawn. These holes should go slightly over the line by no more than 1 or 2mm (0.04 - 0.07"). Then remove all of the material in the centre using the most suitable tools for the material you are cutting.

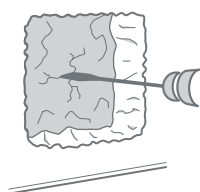

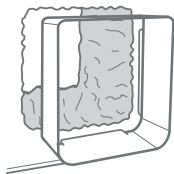

9

It is important not to make the hole too large or you will not be able to screw the pet door to the wall.

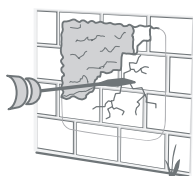

10

Once you have made the hole on the inside of the house, you can move to cutting the hole on the outside of the house. Remember to make the hole on the outside of the house slightly lower than the inside so that rain can run out of the tunnel. Clear away any dust and debris from inside the hole.



11

Fix the tunnel extenders together and to the end of the pet door tunnel using an All-Weather adhesive tape. Do not use glue in case you have to make adjustments or remove the pet door.

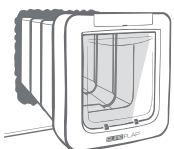

12

From the inside of the house, put the tunnel extenders and pet door into the hole through the wall until the pet door is flush against the wall. At this point you can tell whether the holes are large enough or need adjusting. If no adjustment is necessary you are at the point where you can make the holes for screwing the pet door to the wall.

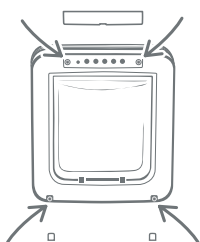

13

The screw holes for mounting the pet door to the wall are underneath the front panel. To remove the front panel, you need to remove the button cover and the two screw caps at the bottom of the pet door. Unscrew the four screws and remove the front panel.





- 14 There are four screw mounting positions for the pet door. Mark on the wall at the four positions using a pencil or pen. Do not drill through the hole as this will get debris and dirt in the locking mechanism of the pet door.

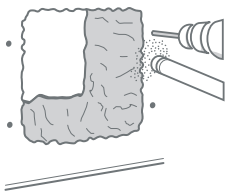

- 15 Remove the pet door and tunnel extenders from the hole in the wall and away from the area while you drill the four holes in the wall.

- 16 Replace the pet door and tunnel extenders in the hole and use any of the screws that came with the pet door to fix the product to the wall. We recommend screwing to the wall by hand so you do not over-tighten the screws.

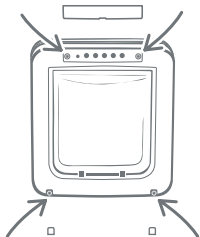

- 17 Replace the front panel using the four screws. Push in the screw caps and replace the button cover.

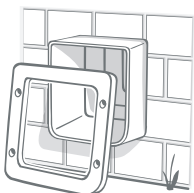

- 18 On the outside of the house you will have the tunnel extenders exiting the wall. Place the external frame over the extender and using a pencil or pen, mark the location for the four screws.



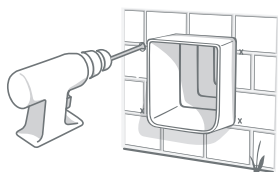

19

Remove the frame and drill the four holes for the screws.

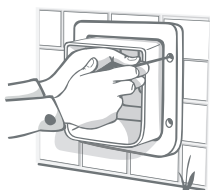

20

Replace the external frame and screw in position. Insert the screw caps.

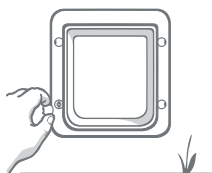

21

Use a silicone sealant around the joint between the tunnel extenders and the external frame and around the top and two side of the frame where it meets the wall.

