



## Installation in:

Glass Doors  
Windows

## Tools you will need:

All Weather Sealant  
Crosshead Screwdriver  
Spirit Level

DIY installation may involve the use of power tools or cut glass. Safety equipment (gloves, eye protection, etc.) should be used and if in doubt consult a professional to carry out the installation.

The SureFlap Microchip Cat Flap is ideal for mounting in single or double glazed windows. If you need to have a hole cut in a window, please ask a qualified glazier to do it, as cutting glass is a skilled job. If you need to get a hole cut in your window, a circular hole with a diameter of 212mm (8.5") is the ideal size. A mounting adaptor is available to complete an installation in glass, and is suitable for covering holes from 210mm (8.5") to 260mm (10.25") in diameter.

For details of where to purchase this adaptor see our website at [www.sureflap.com](http://www.sureflap.com).

If you have a double glazed window, you will need to get a replacement unit manufactured with the hole cut in it. Once your glass has been cut and installed in the door or window you are ready to complete the installation.

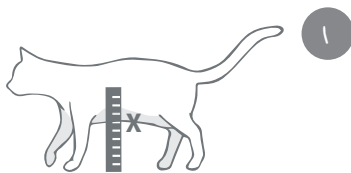

Measure the height of your pet's stomach from the floor when your pet is standing. This height is the level at which the bottom of the hole should be cut through the glass. Make a mark on the glass at this height. Note: If there is a large drop on the outside of the house you will need to place a step outside for your pet to access the tunnel.

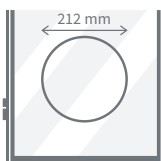

A circular hole 212mm in diameter is required to accommodate the tunnel.



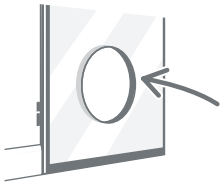

3

If installing the SureFlap Microchip Cat Flap in a double glazed panel your glazier will seal between the panels around the circular hole to avoid moisture collecting inside. Do not use metal in any such seal.

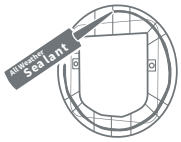

4

We recommend running a bead of 'All Weather Sealant' around the edge of the hole on both sides of the glass. The sealant will help secure the cat flap in place after installation, particularly with larger hole sizes, and also help prevent moisture getting in from outside. This type of sealant can be purchased from a glazing company and most DIY stores.

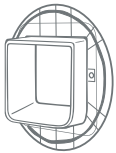

5

Slide one of the mounting adaptor rings over the main assembly.

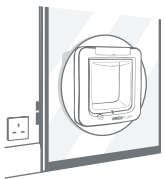

6

From the inside of the house, slide the tunnel of the main assembly through the hole in the glass.

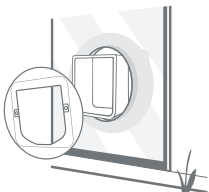

7

From the outside, mount the second part of the mounting adaptor and then the external frame. When working with cut glass always wear protective gloves as the edges may be sharp.

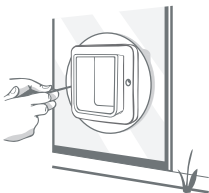

8

Screw the two halves together. If mounting in a single pane, use the shortest of the three pairs of screws. A double glazed panel may require the mid-sized screw, depending on its thickness. Check the assembly is centred with the circular hole before fully tightening the screws.

9

Align the white screw caps with the slot pointing inwards and then push firmly into place.

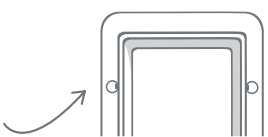

10

From the inside of the house you will now see your cat's stylish new entrance.

